

# \$625,000 - Township Road 550 And Range Road 52, Rural Lac Ste. Anne County

MLS® #E4419708

**\$625,000**

0 Bedroom, 0.00 Bathroom,  
Rural on 315.00 Acres

None, Rural Lac Ste. Anne County, AB

TWO ADJACENT QUARTERS! 315 acres in bush. Located near Darwell. The possibilities are endless with this much land. Currently rented to local farm. Full section is for sale.



## Essential Information

|           |                 |
|-----------|-----------------|
| MLS® #    | E4419708        |
| Price     | \$625,000       |
| Bathrooms | 0.00            |
| Acres     | 315.00          |
| Type      | Rural           |
| Sub-Type  | Vacant Lot/Land |
| Status    | Active          |

## Community Information

|             |                                     |
|-------------|-------------------------------------|
| Address     | Township Road 550 And Range Road 52 |
| Area        | Rural Lac Ste. Anne County          |
| Subdivision | None                                |
| City        | Rural Lac Ste. Anne County          |
| County      | ALBERTA                             |
| Province    | AB                                  |
| Postal Code | T0E 0L0                             |

## Exterior

Exterior Features See Remarks

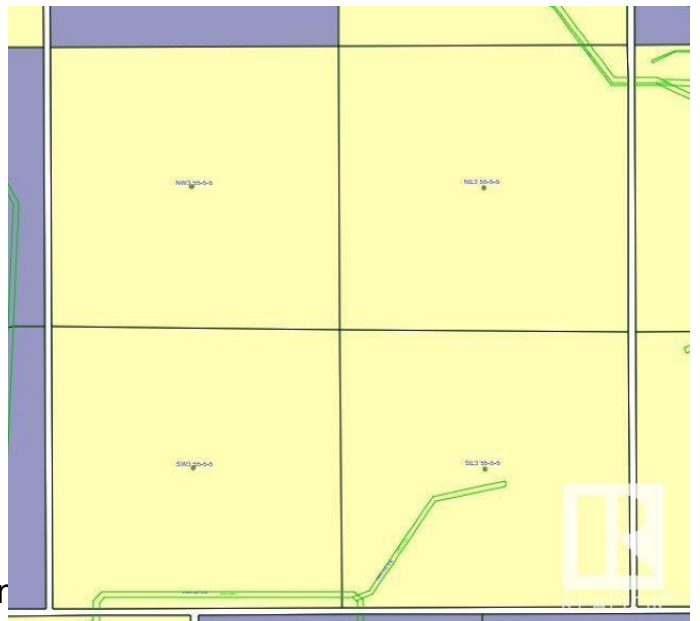

## Additional Information

|                |                    |
|----------------|--------------------|
| Date Listed    | January 28th, 2025 |
| Days on Market | 79                 |
| Zoning         | Zone 70            |

DATA IS DEEMED RELIABLE BUT IS NOT GUARANTEED ACCURATE BY THE REALTORS® ASSOCIATION OF EDMONTON. COPYRIGHT 2025 BY THE REALTORS® ASSOCIATION OF EDMONTON. ALL RIGHTS RESERVED. Trademarks are owned or controlled by the Canadian Real Estate Association (CREA) and identify real estate professionals who are members of CREA (REALTOR®, REALTORS®) and/or the quality of services they provide (MLS®, Multiple Listing Service®)

Listing information last updated on April 17th, 2025 at 8:17pm MDT